

#	DESCRIPTION	DATE	APPROVED
A	WAS ALCTV-2006	3/27/2014	engr
B	ALI VERIFICATION LOGO CHG. ADD SPECS OF BOTH LIFTS	12/1/2015	CHS

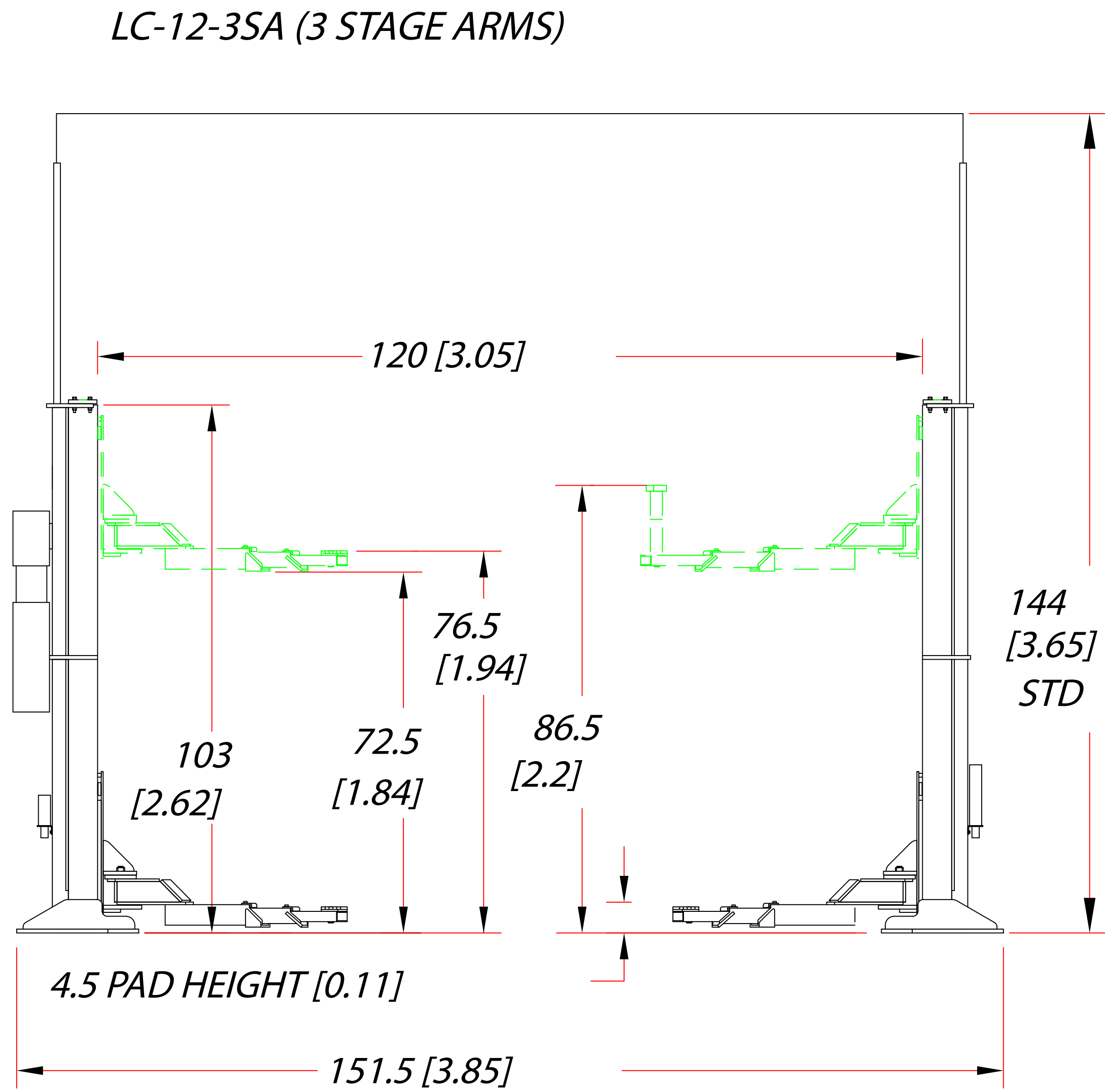

SHOWN WITH ADJUSTABLE HEIGHT  
OVER-HEAD STEEL HYDRAULIC LINES.

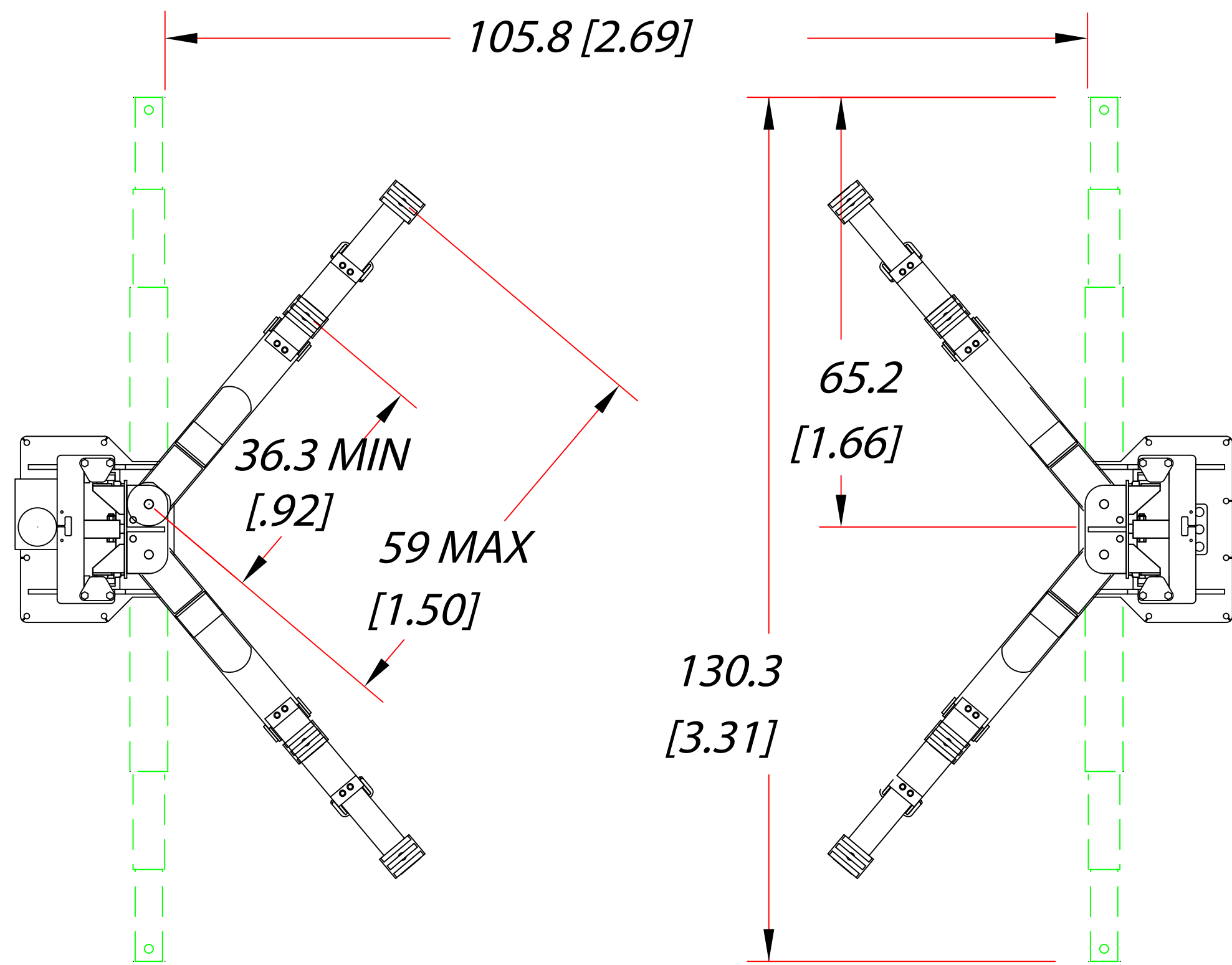

UNITS: INCHES [METERS]

UNITS = INCH (mm)  
= POUND [kg]

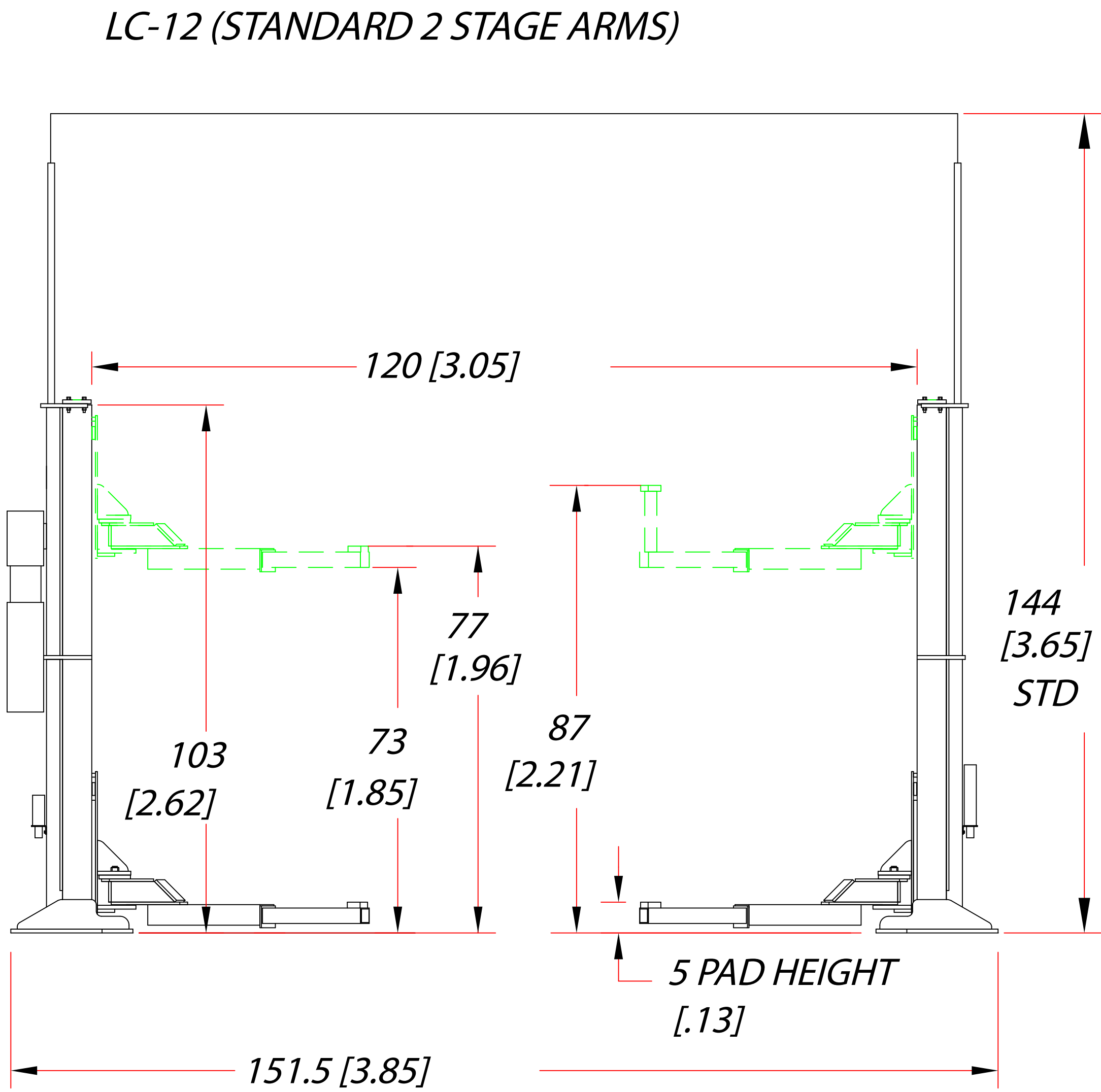

SHOWN WITH ADJUSTABLE HEIGHT  
OVER-HEAD STEEL HYDRAULIC LINES.

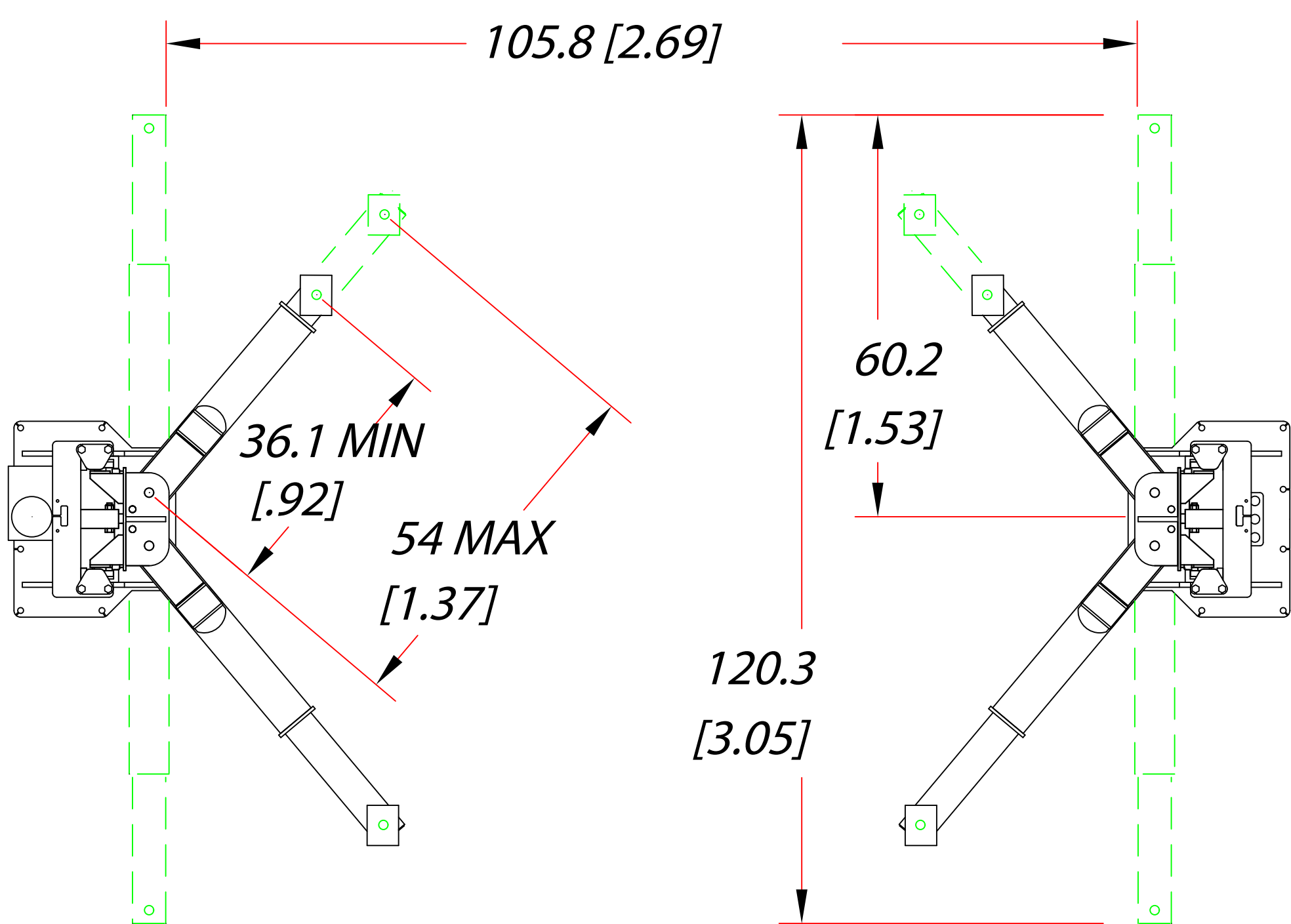

UNITS: INCHES [METERS]

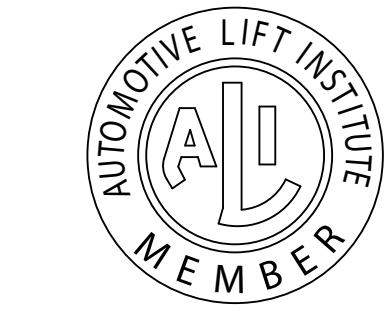

THIS LIFT HAS BEEN TESTED AND CERTIFIED BY A NATIONALLY RECOGNIZED TESTING  
LABORATORY (NRTL) TO MEET THE REQUIREMENTS OF U.L. STANDARD 201 FOR GARAGE  
EQUIPMENT AND ANSI/ALI ALCTV-2011 FOR AUTOMOTIVE LIFT CONSTRUCTION.

## SPECIFICATIONS

SPECIFICATIONS SUBJECT TO CHANGE WITHOUT NOTICE.

MODEL:	LC-12 & LC-12-3SA
Capacity:	12000 lbs. (5443 Kg)
Lifting Speed:	85 sec.
Motor Rating:	2.5 HP/208-230 VAC, single-phase, 60 cycle, (3-phase optional)
Synchronization:	Hydraulic fluid displacement using no chains, cables, or overhead obstructions
Arm Pad Height:	5" (12.7 cm) minimum 4 1/2" (11.4 cm) minimum(3SA)
Lifting Height (Stroke):	6' (1.83 m)
Arm Height @ Full Rise:	6' 5" (1.96 m) 6' 4 1/2" (1.94 m) (3SA)
Max. Pad Height with Adaptors:	7' 2" (2.18 m) 7' 1 1/2" (2.17 m) (3SA)
Overall Width:	12' 7 1/2" (3.85 m)
Width Between Posts:	10' (3.05 m)
Width Between Carriages:	8' 9 3/4" (2.69 m)
Column Height:	8' 7" (2.62 m)
Overall Hydraulic Line Height:	12' (3.65 m) Standard (adjustable to accommodate any height ceiling or routed in-floor).
Weight:	3100 lbs. (1406 Kg)
Concrete Floor Requirements:	4000 PSI (27579.2 kPa) mix 6 1/2" (16.5 cm) depth (14) 3/4" x 6" (1.90x15.2 cm)
Anchoring System:	Wej-it bolts
Mechanical Safety Locks:	Automatic; all position; starting @ 3" (7.62 cm) off the floor
Mechanical Safety Release:	Manual @ both columns
Hydraulic Safety Systems:	Automatic; all position
Swing Arm Restraints:	Automatic restraining upon ascent
Cylinders:	2 (1 per column)
Drive System:	#646 leaf chain routed over cylinder
5" Frame Adaptors (stackable):	4 included as standard equipment
7 1/2" Frame Adaptors (stackable):	4 included as standard equipment
10" Frame Adaptors (stackable):	4 included as standard equipment
Steel Carriage Bearings:	8 per carriage, double- sealed, self-lubricating
Floor Access Between Posts:	clear and unobstructed
Warranty:	5 years Lifetime on cylinders*



MOHAWK RESOURCES LTD.  
P.O. BOX 110  
65 VROOMAN AVENUE  
AMSTERDAM, NY 12010  
PHN: (800) 833-2006  
IN NY: (518) 842-1431  
FAX: (518) 842-1289

NOTE: MOHAWK RESOURCES, LTD. RESERVES THE RIGHT TO MAKE CHANGES WITHOUT NOTICE.

### NOTICE OF CONFIDENTIAL INFORMATION

INFORMATION CONTAINED HEREIN IS CONFIDENTIAL AND PROPERTY OF  
MOHAWK RESOURCES LTD. WHERE DRAWING IS FURNISHED TO OTHERS  
IT SHALL BE USED SOLELY FOR PURPOSES OF INSPECTION, INSTALLATION,  
OR MAINTENANCE. THE INFORMATION SHALL NOT BE USED OR DISCLOSED  
BY THE RECIPIENT FOR ANY OTHER PURPOSES WHATSOEVER.

#### NOTES:

- REMOVE ALL SHARP CORNERS & EDGES.
- UNLESS OTHERWISE SPECIFIED, SURFACE  
FINISH TO BE 125 RMS.
- WELDING MEDIUM SHALL CONFORM TO AWS  
SPECIFICATIONS TO E-70XX ELECTRODES OR  
E-70T1 CODE 5.3 FLUX CORE WIRE ONLY.

TOLERANCES:  
ANGULAR  
FRACTIONAL  
DECIMAL:  
0.XX  
0.XXX

± 1 °  
± .030  
± .030  
± .005

FILE NAME  
LC-12

NEXT ASSEMBLY

SCALE  
n/a

DRAWN  
rvw7089

MOHAWK RESOURCES LTD.

CHECKED

APPROVED

TITLE  
LC-12 Specifications

DATE  
4/2011

WEIGHT  
LB.

FROM  
n/a

DRAWING NUMBER  
LC-12

B